

PLAN SUBMISSION:

Plans can be submitted to the Lawrence County Department of Planning & Community Development office Monday through Friday, 8:00 am—4:00 pm.

CONTACT PERSONS:

Allen J. Miller, Deputy Director of Planning
(724) 656-1907
amiller@lawrencecountypa.gov

Chris Conti, GIS Planner (724) 654-9380
cconti@lawrencecountypa.gov

SUBDIVISION:

The division or re-division of a lot, tract, or parcel of land into two (2) or more lots, tracts, parcels, or other divisions of land, including the changes in existing lot lines. Includes Lot Consolidations.

LAND DEVELOPMENT:

The improvement of one (1) lot or two (2) or more contiguous lots, tracts, or parcels of land for any purpose involving a group of two (2) or more residential buildings, or one (1) or more nonresidential buildings on a lot or lots.

QUESTIONS TO ASK:

Is my lot large enough to subdivide?
What provision will be made for wastewater?
What is the nature and extent of access to the property?
Does this project fit with local zoning and building requirements?
Who will prepare the plans?
Will stormwater or erosion and sedimentation be affected?

Lawrence County Department of Planning & Community Development

Lawrence County Government Center
430 Court Street
New Castle, PA 16101

Phone: (724) 656-2144
Fax: (724) 656-2151
E-mail: amckinney@lawrencecountypa.gov

Municipalities subject to County Subdivision and Land Development Ordinance*

Ellport Borough
Enon Valley Borough
Little Beaver Township
Perry Township
Plain Grove Township
S.N.P.J. Borough
Volant Borough
Wampum Borough
Washington Township

*Plans in other municipalities must be submitted to the municipality first and forwarded to our department.

Mission Statement: The Lawrence County Planning Commission members and staff are committed to systematically organize, lead, direct, educate, and administer planning as required by the Pennsylvania Municipalities Planning Code, so as to maximize the economic, environmental, and social development of Lawrence County and the Commonwealth of Pennsylvania.



Lawrence County Subdivision & Land Development Procedures



Lawrence County Commissioners

Daniel J. Vogler, Chairman
Dan Kennedy
Chris Sainato

Lawrence County Planning Commission Members

Karolee Loughhead, Chairperson
Mary Burris, Vice-Chairperson
Cindy Morabito, Secretary
Everett Bleakney
James Blundo
Maxwell Frederick (alternate)
Jim Gagliano (alternate)
Dave Hammond
Larry Lambo
John Logue (alternate)
Hygeia Moss-Eggleston (alternate)
Linda Nitch
Frank Telesz

SUBDIVISION & LAND DEVELOPMENT REVIEW PROCESS



TYPES OF SUBDIVISIONS

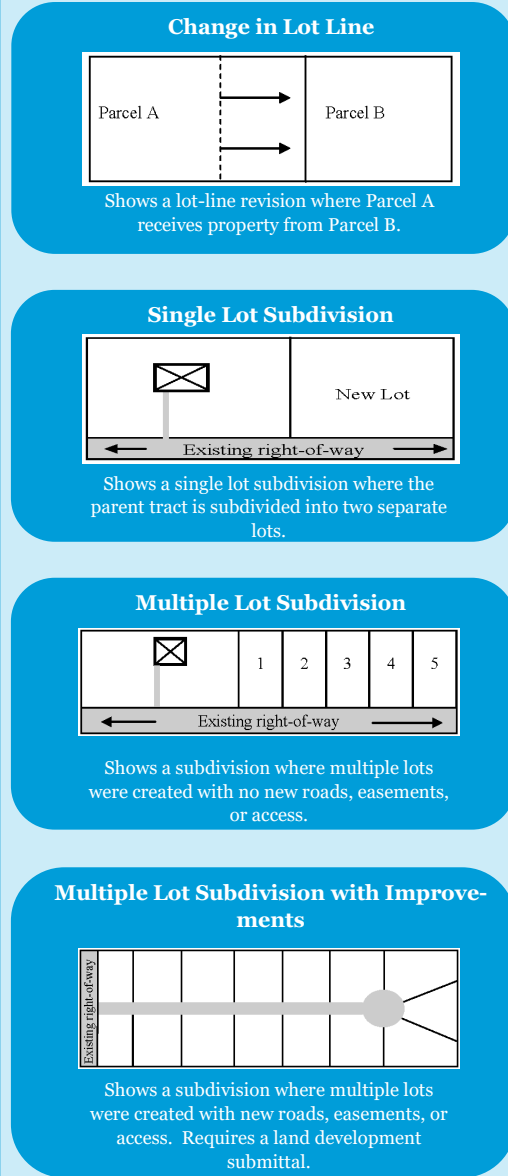

TYPES OF LAND DEVELOPMENTS

